

375-395W 0-5W Positive Tolerance



MBB&SMBB Half-cut Cell Technology

New circuit design, lower internal current, and lower Rs loss.



High Power Density

A new generation of monocrystalline products with reduced resistive losses for greater power output.



Mechanical Properties

An aluminum frame in special design for better mechanical properties and more efficient installation.



Excellent Weather Resistance

The solar modules can meet the IEC standard requirements with strong resistant to risks such as salt spray, ammonia gas, dust, snail marks and electric potential induced attenuation.



4 Times 100% EL Detection

Guarantee no micro cracks

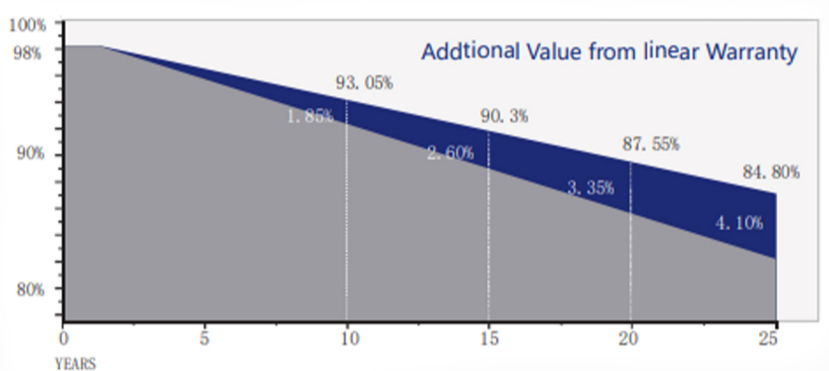
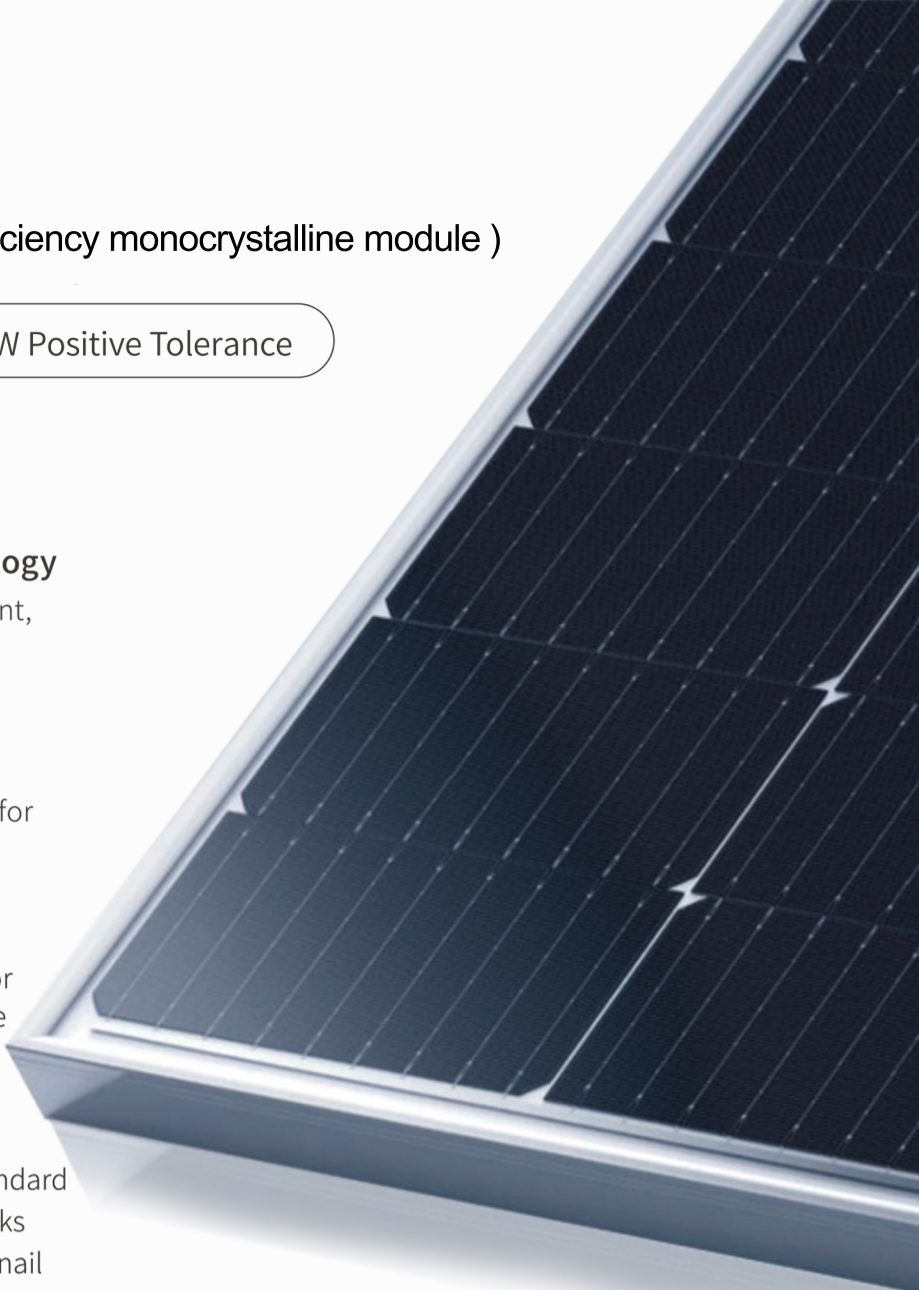

PRODUCT QUALITY SYSTEM & CERTIFICATION



12years Material & process Warranty

25years Linear Performance Warranty

0.55% Linear Power Degradation

ELECTRICAL PROPERTIES

SF-166M-40H

80PCS

	STC	NMOT	STC	NMOT	STC	NMOT	STC	NMOT	STC	NMOT
Maximum Power P_{mp}	375W	278W	380W	281W	385W	286W	390W	290W	395W	294W
Open Circuit Voltage- V_{oc}	41.6V	39.3V	41.7V	39.4V	41.5V	39.3V	41.7V	39.5V	41.9V	39.7V
Short Circuit Current- I_{sc}	11.85A	9.57A	11.98A	9.67A	11.83A	9.55A	11.92A	9.62A	11.99A	9.68A
Max Power Voltage- V_{mp}	34.2V	32.3V	34.6V	32.4V	35.0V	33.2V	35.2V	33.4V	35.4V	33.6V
Max Power Current- I_{mp}	10.98A	8.61A	10.99A	8.67A	11.01A	8.61A	10.09A	8.68A	11.17A	8.75A
Module Efficiency STC- η_m	20.6%		20.9%		21.1%		21.4%		21.7%	
Power Tolerance(W)	0~+5W									
Maximum System Voltage	1500V DC									
Max Serise Fuse Rating	20A									

STC: irradiance 1000W/m² module temperature 25°C AM=1.5
 NMOT: irradiance of 800W / m², ambient temperature 20°C, and wind speed 1m / s

Temperature characteristic

Pmax Temperature Coefficient	-0.35 %/° C
Voc Temperature Coefficient	-0.26 %/° C
Isc Temperature Coefficient	+0.047 %/° C
Operating Temperature	-40~+85 ° C
Nominal module operation temperature	45 ± 2 ° C

Mechanical Specifications

External Dimension	1755*1038*35mm
Weight	19.5kg
Solar Cell	Mono crystalline 166*83mm, 120 (6*20)
GLASS	High transmission tempered glass
Frame	Anodized aluminum alloy
Junction Box	IP68, 3diodes, MC4 compatible
Output Cables	4.0mm ² , 200mm(+)/300mm(-) or Customized Length
Mechanical Load	Front side 5400pa/Back side 2400pa
Packaging Configuration	31pcs / box, 806pcs / 40' HQ Container

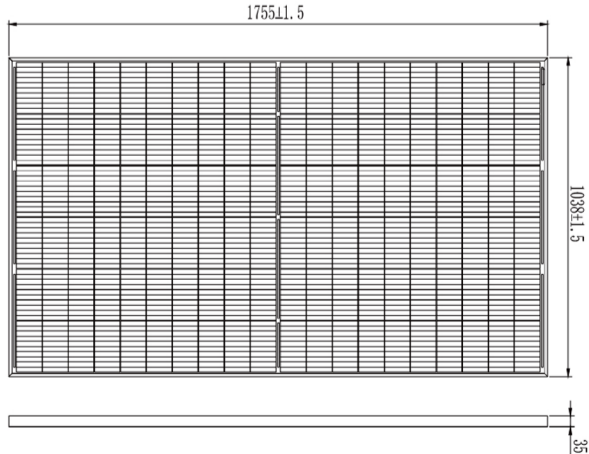
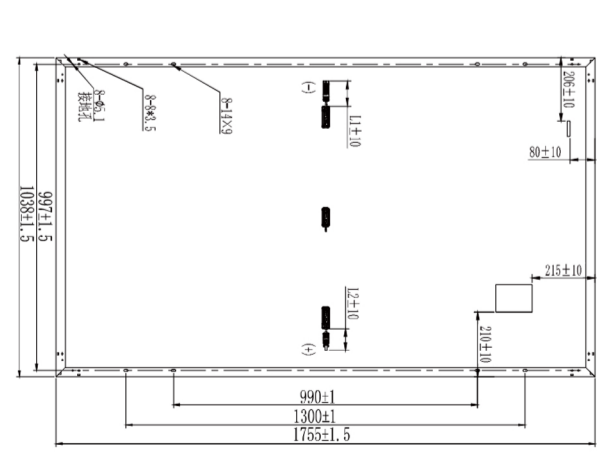
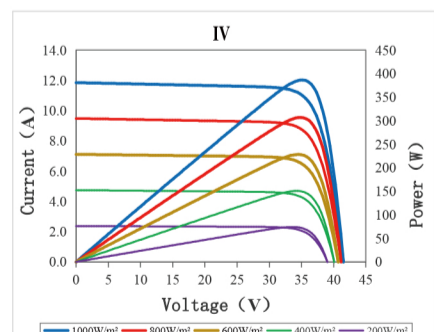

Technical drawings

